

Illustrations	Numéros Numbers	Cannelures Femelles Fem splines	Cannelures Mâles Male splines	Longueur (inches) Length	Allonge le "PTO" Extends tractor PTO
	32-355 32-363 P240	31/32" - 10 1-1/8" - 6 1-1/8" - 6	1-3/8" - 6 1-3/8" - 6 1-3/8" - 6	2-1/4" 2" 2-3/16"	IHC Cub & Kubota (Ford 231082) (Ford 231082)
	32-018 P245	1-1/8" - 6 1-1/8" - 6	1-3/8" - 6 1-3/8" - 6	3" 3-3/16"	1-1/8" 1-3/32"
	32-3531 P244 32-420 P243 32-401 32-377 32-378 P246 32-371 P247 P248 P249 32-373 32-070	1-1/8" - 6 1-1/8" - 6 1-3/8" - 6 1-3/8" - 6 1-3/4" - 6 1-1/8" - 6 1-3/8" - 6 1-3/8" - 6 1-3/8" - 6 1-3/8" - 6 1-3/8" - 6 1" - 18 1-3/8" - 21 1-3/8" - 21 1-3/8" - 21	1-3/8" - 6 1-3/8" - 6 1-1/8" - 6 1-1/8" - 6 1-3/8" - 6 1-1/8" - 6 1-3/8" - 6 1-3/8" - 6 1-3/8" - 6 1-3/8" - 6 1-3/8" - 6 1-3/8" - 6 1-3/8" - 6 1-3/4" - 20	5-1/2" 4-3/4" 5-1/8" 5-3/8" 6-1/2" 5-1/2" 5-1/8" 5-7/16" 6-1/2" 6-7/16" 5" 6-1/8" 6-1/2" 7	3-3/4" Cross pin 2-3/4" 3-5/16" Cross pin 4-3/16" 4-3/4" 3-3/4" Cross pin 3-5/16" Cross pin 3-13/16" 4-3/8" Cross pin 5" 3" 3-1/2" 4-3/8" Set screw 4-1/2" Set screw
	32-013 32-1373 32-010 32-2121	1-3/8" - 6 1-3/8" - 21 1-3/8" - 6 1-3/8" - 21	1-3/8" - 21 1-3/8" - 6 1-3/8" - 6 1-3/8" - 21	6-1/2" 6-1/2" 6-1/2" 6-1/2"	4-3/8" 4-3/8" 4-3/8" 4-3/8"
 <b>Quick release adaptors</b>	P250 P251 P620	1-3/8" - 21 1-3/8" - 6 1-3/8" - 6	1-3/8" - 6 1-3/8" - 6 1-3/8" - 21	6-1/2" 6-1/2" 6-1/2"	4-1/4" 4-1/4" 4-1/4"
	32-1476 P459 32-1477 P460	1-3/4" - 20 1-3/4" - 20 1-3/4" - 20 1-3/4" - 20	1-3/8" - 6 1-3/8" - 6 1-3/8" - 21 1-3/8" - 21	8-3/16" 7-3/8" 8-3/16" 7-3/8"	5-3/16" 5" 5-3/16" 5"
	S4176	Jeu de réparation 3" - <i>Quick disconnect pin kit 3"</i>			
	F6009	Jeu de réparation 2-1/16" - <i>Quick disconnect pin kit 2-1/16"</i> <i>Référence 228163X</i>			
	32-086	Ensemble de réparation - <i>Repair kit for 32-010, 013, 1373, 2121</i>			

**NOTE:** Tous les modèles (#32-) ont une **capacité maximum de 75 forces...**à moins que spécifié autrement.  
**Les modèles (P) n'ont aucune garantie.**

**NOTE:** *All models (#32-) maximum capacity of 75 H.P..unless specified differently.*  
**All models (P) have no warranty.**

NUMÉROS NUMBERS	TROUS I.D.	DIAM EXT O.D.	CANNELURES SPLINES	LONGUEUR LENGTH	ILLUSTRATIONS
32-027 32-028 32-043 32-350 P613 32-034 32-037 32-351 32-030 32-066 P612	5/8" 7/8" 1" 1-3/8" 1-3/8" 1-1/4" 2-1/8" 1-3/4" 1-3/4" 3/4" 1-3/8"	1-3/8" 1-3/8" 1-1/2" 1-3/4"  2.251" 3.501" 2-1/4" 2-1/4" 1-3/8"	9 13 15 21 21 14 16 27 13 11 6	2" 3" 3" 3" 3-3/4" 2" 2-31/32" 3" 3-3/4" 2" 3-3/4"	<p><b>MOYEUX &amp; ACCOUPLEMENTS À CANNELURES</b></p>  <p><b>SPLINED HUBS &amp; INVOLUTE SPLINED COUPLINGS</b></p>
32-023 32-024 32-044 32-025 32-395	5/8" 7/8" 1" 1-1/4" 1-3/8"		9 13 15 14 21	6" 6" 8" 10" 10"	<p><b>ARBRE À CANNELURES</b></p>  <p><b>INVOLUTE SPLINED SHAFTS</b></p>
	<b>Cann Fem Splines Fem</b>	<b>Keyway</b>	<b>Dia rond Round dia</b>	<b>Longueur Length</b>	
32-407 32-408 32-409 32-410 32-411 32-608	1-3/8" - 6 1-3/8" - 6 1-3/8" - 6 1-3/8" - 6 1-3/8" - 6 1-3/8" - 21	3/16" x 3/32" 3/16" x 3/32" 3/16" x 3/32" 1/4" x 1/8" 1/4" x 1/8" 3/16" x 3/32"	5/8" 3/4" 7/8" 1" 1-1/8" 3/4"	4-1/8" 4-1/8" 4-1/8" 4-1/8" 4-1/8" 4-1/8"	<p><b>ADAPTEURS D'ENTRAÎNEMENT DE POMPE À CANNELURES</b></p>  <p><b>SPLINED PUMP DRIVE ADAPTORS</b></p>
32-012 * 32-014 * 32-011 * 32-016 * 32-017 *	1-3/8" - 6 1-3/8" - 6 1-3/8" - 6 1-3/8" - 6 1-3/8" - 6	3/16" x 3/32" 3/16" x 3/32" 3/16" x 3/32" 1/4" x 1/8" 1/4" x 1/8"	5/8" 3/4" 7/8" 1" 1-1/8"	4-1/8" 4-1/8" 4-1/8" 4-1/8" 4-1/8"	 <p><b>* KWIK-D-TACH</b> (32-608 Supplied w/set-screws)</p>
	<b>O.D.</b>	<b>Keyway</b>	<b>Diam rond Round dia</b>	<b>Longueur Length</b>	
32-380 32-381 32-382 32-384 32-386 32-388 32-379	1-1/2" 1-1/2" 1-3/4" 2" 2" 2-1/8" 2-1/4"	3/16" 3/16" 1/4" 1/4" 1/4" 5/16" 3/8"	3/4" 7/8" 1" 1-1/8" 1-1/4" 1-3/8" 1-1/2"	2-3/4" 2-3/4" 2-3/4" 3" 3" 3" 3"	<p><b>RACCORDEMENTS À PERCAGE ROND</b></p>  <p><b>ROND BORE COUPLINGS</b></p>

**Les numéros (P) n'ont aucune garantie / All models (P) have no warranty.**



Numéros <i>Numbers</i>	Cannelures Femelles <i>Fem splines</i>	Cannelures Mâles <i>Male splines</i>	Longueur (inches) <i>Length</i>	Allonge le "PTO"		ILLUSTRATIONS
				<i>Extends tractor PTO</i>		
				<i>Shaft end</i>	<i>Shaft Retaining Groove</i>	

### OVER-RUNNING COUPLERS

*"Over-Running couplers drive solidly from tractor to driven implement, free wheel smoothly when implement exceeds P.T.O. speed"*

ACCOUPLLEMENTS DE  
PROTECTION DE  
SURVIVAGE

31-010	1-3/8" - 6	1-3/8" - 6	7-5/16"	4-13/16"	5-3/16"	<b>125 HP</b>	
31-011	1-3/8" - 6	1-3/8" - 21	7-3/16"	4-11/16"	5-3/16"	<b>125 HP</b>	
31-012	1-3/8" - 21	1-3/8" - 6	7-5/16"	5-5/16"	5-3/16"	<b>125 HP</b>	
31-013	1-3/8" - 21	1-3/8" - 21	7-3/16"	5-3/16"	5-3/16"	<b>125 HP</b>	
37-126	Repair kit						

### ÉQUIPEMENT RÉGULIER DE TRACTEUR JUSQU'À 75 FORCES

31-660	1-3/8" - 6	1-3/8" - 6	6-21/32"	4-5/32"	4-1/32"	
31-670	1-1/8" - 6	1-3/8" - 6	6-21/32"	4-5/32"	4-1/32"	
31-680	1-3/8" - 6	1-1/8" - 6	6-21/32"	4-5/32"	4-1/32"	
31-690	1-1/8" - 6	1-1/8" - 6	6-21/32"	4-5/32"	4-1/32"	
37-076	Repair kit					

### SPLINED COUPLERS

	<i>Cannelures Splines</i>	<i>Longueur Length</i>	<i>O.D.</i>		ACCOUPLLEMENTS CANNELE
32-336	3/4" - 6	2-1/2"	1-3/8"	(Kubota & IHC cab)	  SPLINED COUPLINGS
32-337	7/8" - 6	2-1/2"	1-3/8"		
32-338	1" - 10	2-1/2"	1-3/8"		
32-340	31/32" - 10	2-3/4"	1-3/8"		
32-341	1" - 6	2-3/4"	1-3/8"		
32-342	1-1/4" - 6	3-1/4"	1-7/8"		
32-344	1-1/8" - 6	2-3/4"	1-9/16"		
32-345	1-3/8" - 6	3-3/4"	1-3/4"		
32-346	1-3/4" - 6	3-3/4"	2-1/4"		
32-348	1-1/4" - 10	3-3/4"	1-3/4"		

NUMÉROS NUMBERS	DESCRIPTION
<b>20-6206</b>	Diminueur de vitesse 1000: 540 Tours - <i>PTO Speed reducer 1000:540 RPM</i>
<b>20-6207</b>	Augmenteur de vitesse 540: 1000 Tours - <i>PTO Speed increaser 540: 1000 RPM</i>
<b>20-6208</b>	Diminueur de vitesse 1000: 540 Tours - <i>PTO Speed reducer 1000: 540 RPM</i>

**IMPORTANT:** The model 390 P.T.O. speed changers can be mounted on most tractor P.T.O. shafts, however, they cannot be mounted on tractors that do not have detachable P.T.O. shields. Unit must be used in an approved mounting position with the torque arm bracket also in an approved position otherwise excessive side loading will be exerted on the tractor P.T.O. shaft. The torque arm must always be positioned at 90° to the torque arm bracket.

Assembly No.	20-6206	20-6207	20-6208
<b>Ratio</b>	1.89:1 Reducer	1: 1.89 Increaser	1.89:1 Reducer
<b>Tractor RPM</b>	1000	540	1000
<b>Drive line RPM</b>	540	1000	540
<b>Female Spline</b>	1-3/8 - 21 inv	1-3/8 - 6B	1-3/4 - 20 inv
<b>Male Spline</b>	1-3/8 - 6B	1-3/8 - 21 inv	1-3/8 - 6B
<b>C.D. Center distance</b>	1.60	1.60	1.60
<b>A</b>	8-1/8	7-5/8	8-11/32
<b>B</b>	9-1/2	9-1/2	9-1/2
<b>C.D. Center distance</b>	5-3/4	5-3/4	5-3/4
<b>Drive Line RPM</b>	11-1/8	11-1/8	11-1/8
<b>E</b>	4-1/4	3-9/16	4-1/4
<b>F P.T.O. Ext</b>	11-5/8	10-15/16	10-31/32
<b>G</b>	14-5/8	13-15/16	14-27/32
<b>H</b>	10-3/8	9-3/8	10-19/32
<b>I</b>	1-1/16	1	1-5/16
<b>J</b>	5-3/8	5-3/8	5-3/8
<b>K</b>	10-3/4	10-3/4	10-3/4
<b>L</b>	5-3/4	5-3/4	5-3/4
<b>M</b>	13-1/8	13-1/8	13-1/8
<b>N</b>	7-7/8	7-7/8	7-7/8
<b>O</b>	6-9/32	7-7/8	6-9/32

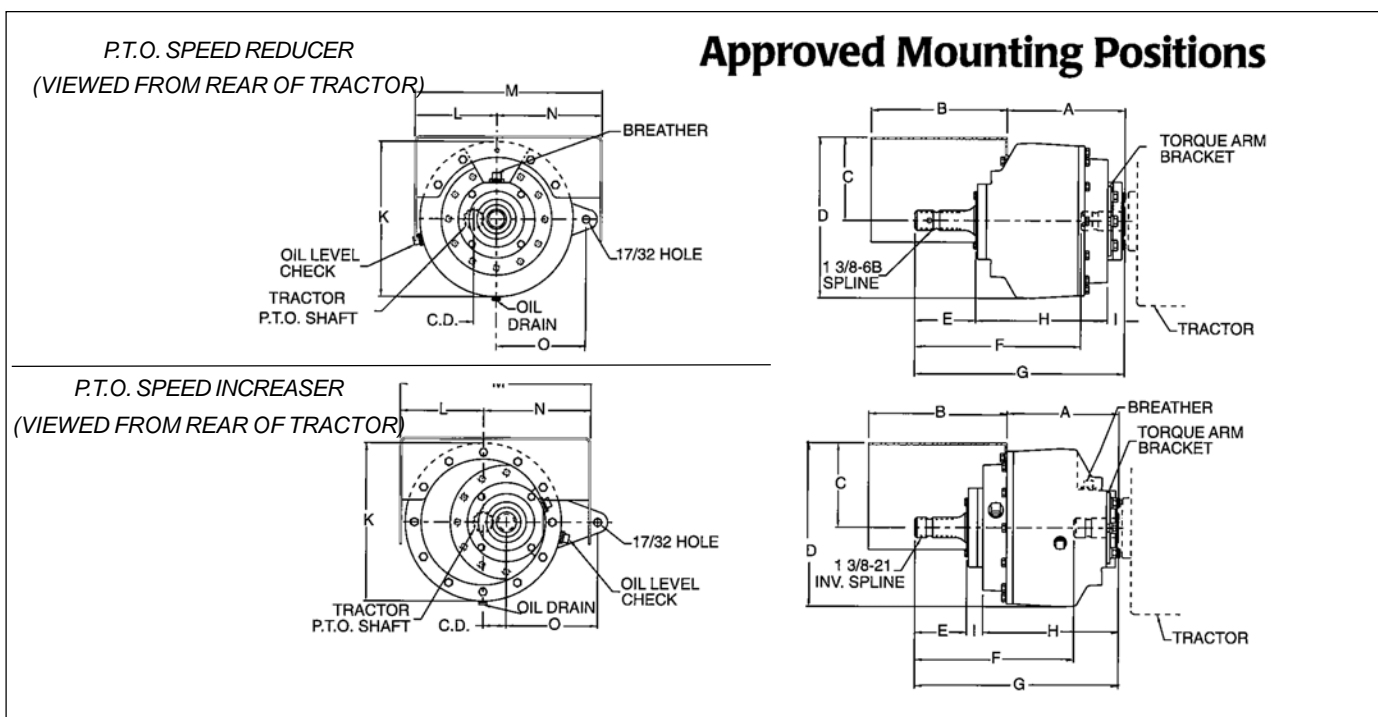
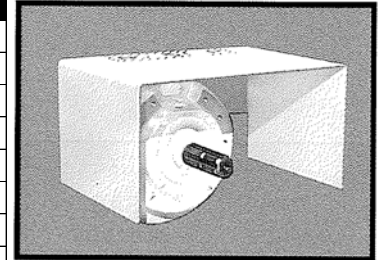

## RACCORD HEXAGONAL HEXAGONAL COUPLER

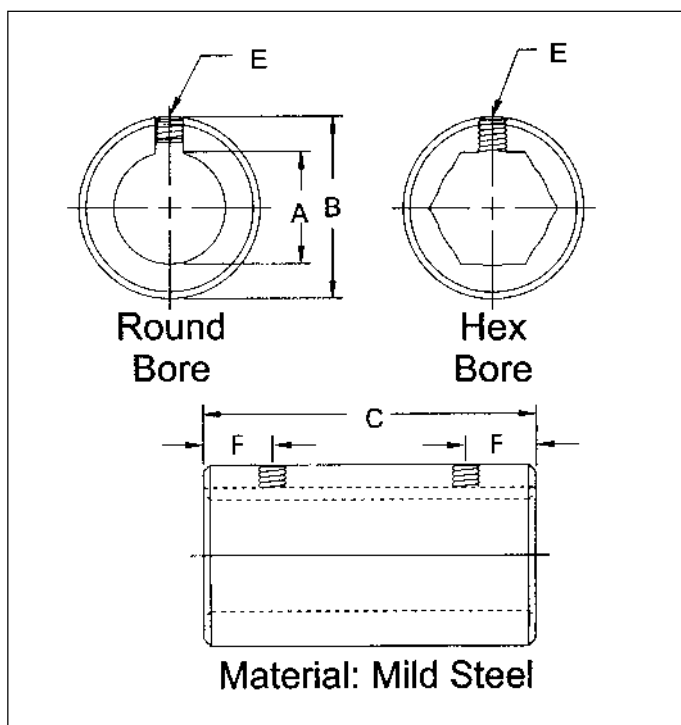

Numéros	A	B	C	E	F	Wt lbs
DA6000-1000	5/8 Hex	1-1/2	2-1/2	2-1/4 x 20	5/8	0,51
DA6000-1200	3/4 Hex	1-5/8	3	2-1/4 x 20	5/8	0,93
DA6000-1400	7/8 Hex	1-3/4	3	2-1/4 x 20	5/8	1,32
DA6000-1600	1 Hex	1-13/16	3	2-5/16 x 18	5/8	1,38
DA6000-1800	1-1/8 Hex	2	4-1/2	2-5/16 x 18	1	2,69
DA6000-2000	1-1/4 Hex	2-1/8	4-1/2	2-5/16 x 18	1	2,88
DA6000-2400	1-1/2 Hex	2-3/4	4-1/2	2-5/16 x 18	1-1/8	5,00
DA6000-2800	1-3/4 Hex	3	4-1/2	2-5/16 x 18	1-1/8	5,55